



# Anchor Socket Installation Tips

## Choosing the Correct Socket:

Choosing the correct socket is important for a safe long lasting pool.

	Aluminum	Plastic	Bronze
Residential / Chlorinated	X	X	X
Residential / Salt System		X	X
Commercial			X

### Bronze Sockets

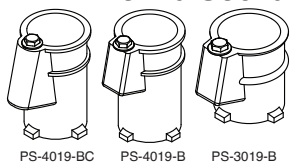

### Aluminum Sockets

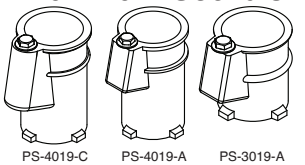

### Plastic

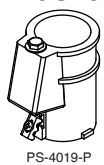

## Anchor Socket Drainage:

It is critical that anchor socket drain holes are always open and free of debris. This should not only be checked during installation but periodically through the season to allow proper drainage. Improper drainage can cause corrosion which could lead to injury or damage to pool deck and equipment.

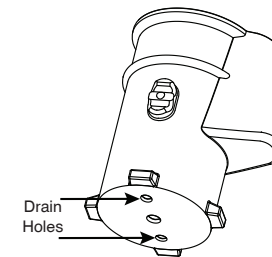

## Anchor Socket Bonding:

All Anchor Sockets should be bonded to the pool bonding grid. Be sure to follow all NEC and local building codes.

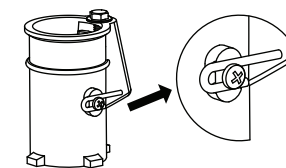

## Getting the Right Fit:

Determine the correct location and placement of anchor socket.

It is important that the ladder and handrail have the proper **anchor setback**, **anchor distance**, be **flush** with the top of the deck, and be **level**. By not checking all these measurements could cause **injury** or **damage** to pool deck and pool equipment.

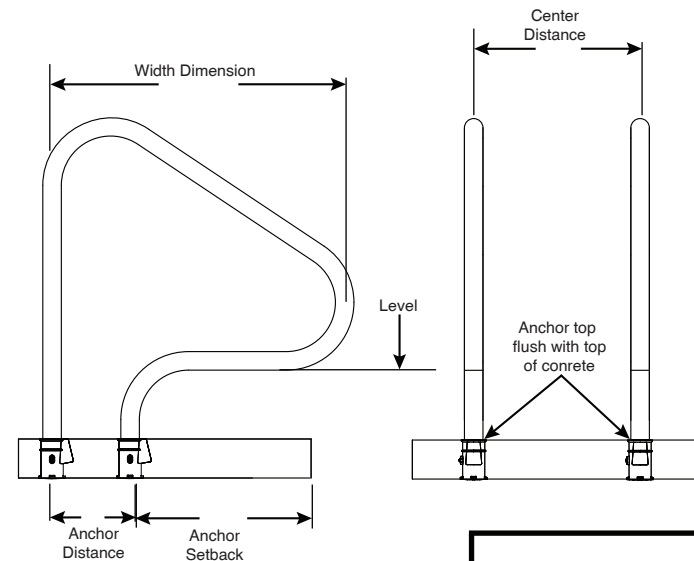
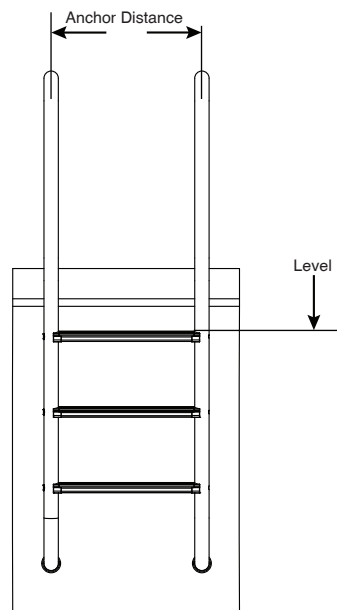
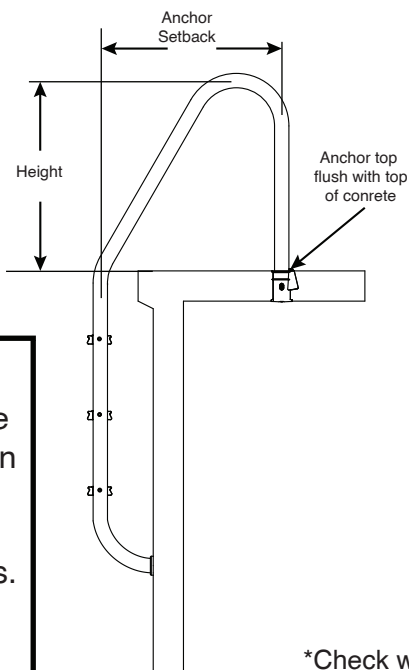

## Concrete:

When selecting concrete make sure the minimum compression strength is 3000 PSI. Also allow the cement to cure per the manufacturer's instructions. Along with following all local building codes.

\*Check with your Handrail and Ladder Manufacturer for proper measurements.\*

Perma-Cast Co. Pueblo, CO  
[www.permacastonline.com](http://www.permacastonline.com)  
 Call 719-544-9544